

阿久根高尾野道路 30-3工区 平面図 S=1:1,000

本線 中心点座標一覧表

点名称	X座標	Y座標
NO.117	-106663.028	-67819.855
NO.118	-10652.817	-67837.051
NO.119	-106642.039	-67853.897
NO.120	-106630.705	-67870.375
NO.121	-106618.828	-67886.465
+10.0	-106612.690	-67894.360
KE3-2	-106608.350	-67899.783
NO.122	-106606.421	-67902.151
NO.123	-106593.516	-67917.429
NO.124	-106580.185	-67932.338
+7.0	-106575.433	-67937.477
NO.125	-106566.503	-67946.925
+7.0	-106561.645	-67951.965
NO.126	-106552.542	-67961.246
NO.127	-106538.370	-67975.357
NO.128	-106524.050	-67989.320
NO.129	-106509.648	-68003.197
KA3-2 (BC4)	-106504.638	-68008.007
NO.130	-106495.280	-68017.109
NO.131	-106481.176	-68031.289
NO.132	-106467.359	-68045.748
NO.133	-106453.833	-68060.481
NO.134	-106440.605	-68075.481
NO.135	-106427.679	-68090.742
NO.136	-106415.062	-68106.259
NO.137	-106402.757	-68122.025
NO.138	-106390.769	-68138.035
NO.139	-106379.105	-68154.280
+10.0	-106373.395	-68162.490
NO.140	-106367.767	-68170.756

本線 中心点座標一覧表

点名称	X座標	Y座標
SP4	-106361.222	-68180.599
NO.141	-106356.762	-68187.455
NO.142	-106346.092	-68204.371
+10.0	-106340.885	-68212.908
NO.143	-106335.763	-68221.497
NO.144	-106325.779	-68238.826
+10.0	-106320.917	-68247.565
NO.145	-106316.143	-68256.351
NO.146	-106306.859	-68274.066
NO.147	-106297.932	-68291.962
NO.148	-106289.364	-68310.034
NO.149	-106281.159	-68328.273
+14.0	-106275.634	-68341.137
NO.150	-106273.321	-68346.673
NO.151	-106265.853	-68365.226
EC4 (BC5)	-106259.903	-68380.824
NO.152	-106258.754	-68383.923
NO.153	-106251.908	-68402.715
NO.154	-106245.250	-68421.574
NO.155	-106238.781	-68440.499
NO.156	-106232.502	-68459.488
+13.0	-106228.522	-68471.864
NO.157	-106226.413	-68478.538
NO.158	-106220.515	-68497.649
NO.159	-106214.808	-68516.817
NO.160	-106209.293	-68536.042
SP5	-106204.622	-68552.920
NO.161	-106203.971	-68555.318
NO.162	-106198.842	-68574.649
NO.163	-106198.842	-68574.649

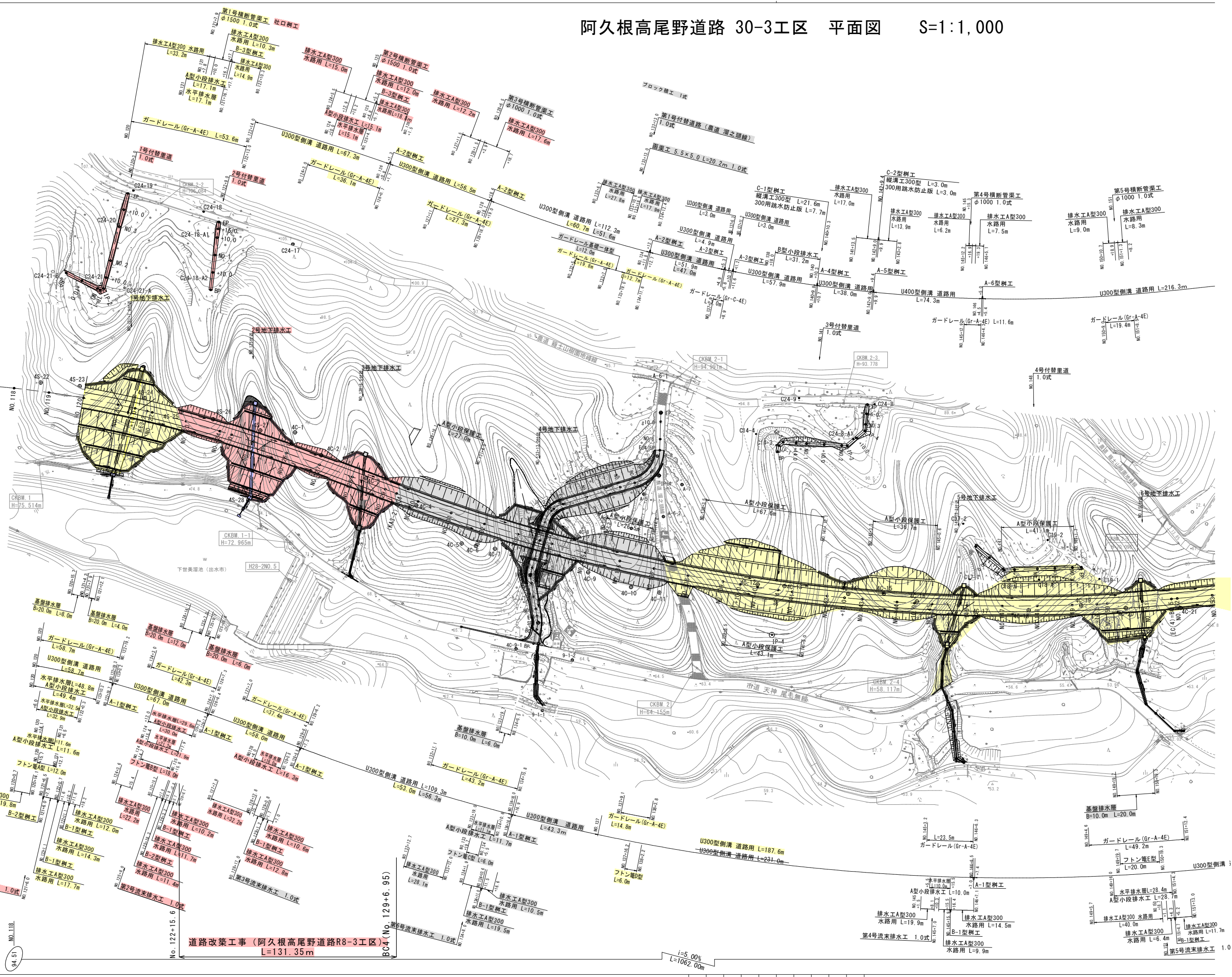

道路改築工事 (阿久根高尾野道路R8-3工区) L=131.35m

94.51

1:5.00% L=1062.00m

道路改築工事（阿久根高尾野道路R8-3工区）

縦断図 S $\begin{cases} V=1:200 \\ H=1:1000 \end{cases}$

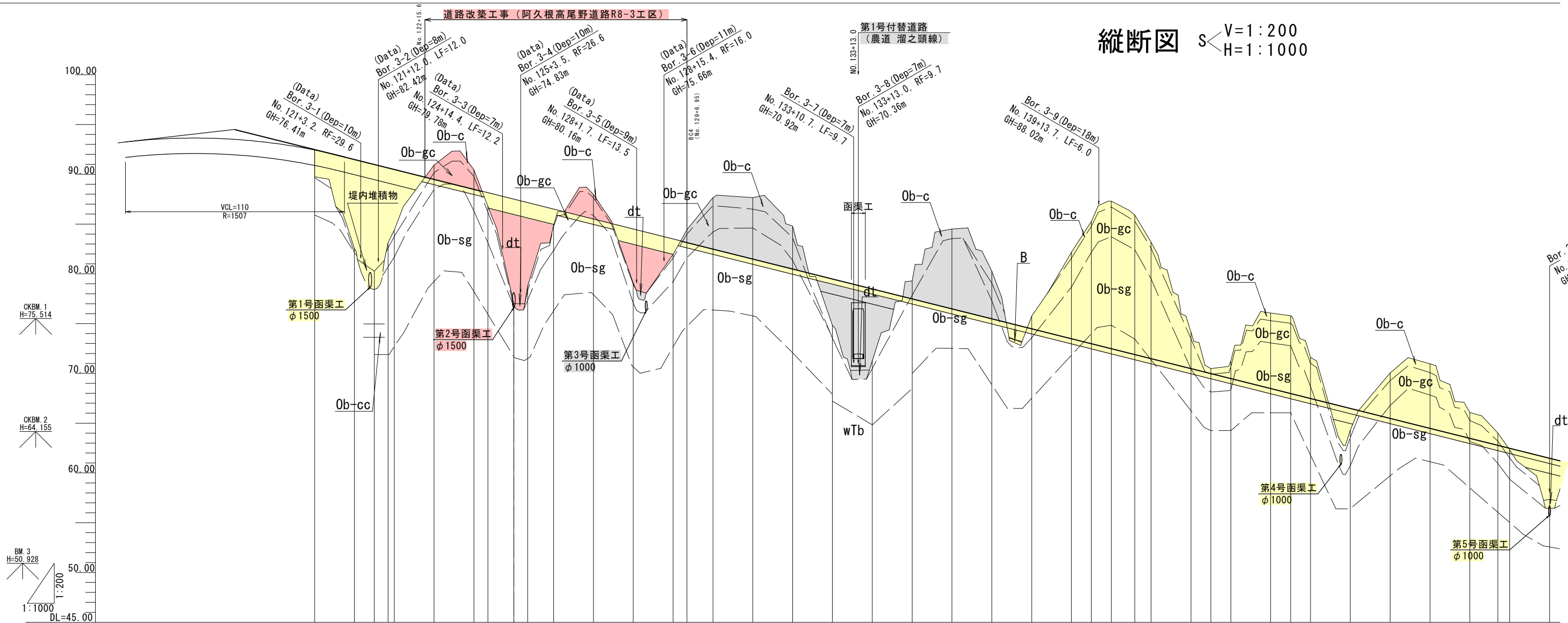

勾配	94.51		$i=5.00\%$ $L=1062.00m$																																							
盛土	2.72	8.95	10.75	7.52	6.12	1.40	10.49	8.39	1.63	5.44	1.56	4.67	7.25	2.22	0.18	4.17																										
切土						1.42	1.95		2.46	1.28	5.15	6.15	4.28	1.78	8.00	4.75	1.25	8.66	12.25	14.79	13.99	11.66	3.63	0.47	1.76	7.55	7.78	4.09	4.54	6.46	2.57	1.21										
計画高	92.44	91.51	91.01	90.95	90.51	89.51	88.51	88.16	87.51	87.16	86.51	85.51	84.51	83.51	83.16	82.51	81.51	80.51	79.51	78.51	77.51	76.51	75.51	74.51	73.51	73.01	72.51	71.92	71.51	70.51	70.01	69.51	68.51	68.01	67.51	66.51	65.51	64.51	63.51	62.51	62.51	61.51
地盤高	89.75	82.56	80.26	83.14	84.39	90.93	90.46	86.76	77.02	78.77	84.88	87.97	79.07	81.95	84.44	87.66	87.66	84.79	74.84	71.26	79.29	84.51	80.26	75.76	82.17	85.26	87.30	85.91	83.17	74.14	70.48	71.27	76.06	75.79	71.60	64.29	70.05	70.97	66.08	64.02	62.33	57.34
追加距離	2400.00	2420.00	2430.00	2436.95	2440.00	2460.00	2480.00	2487.00	2500.00	2507.00	2520.00	2540.00	2560.00	2580.00	2586.95	2600.00	2620.00	2640.00	2660.00	2680.00	2700.00	2720.00	2740.00	2760.00	2780.00	2790.00	2800.00	2811.82	2820.00	2840.00	2850.00	2860.00	2880.00	2890.00	2900.00	2920.00	2940.00	2960.00	2980.00	2994.00	3000.00	3020.00
単距離	0.00	20.00	10.00	6.95	3.05	20.00	20.00	7.00	13.00	7.00	13.00	20.00	20.00	20.00	6.95	13.05	20.00	20.00	20.00	20.00	20.00	20.00	20.00	20.00	20.00	10.00	10.00	11.82	8.18	20.00	10.00	10.00	20.00	10.00	10.00	20.00	20.00	20.00	14.00	6.00	20.00	
測点	No. 120	No. 121	+10.0	KE3-2	No. 122	No. 123	No. 124	+7.0	No. 125	+7.0	No. 126	No. 127	No. 128	No. 129	MA3-2#04	No. 130	No. 131	No. 132	No. 133	No. 134	No. 135	No. 136	No. 137	No. 138	No. 139	+10.0	No. 140	SP.4	No. 141	No. 142	+10.0	No. 143	No. 144	+10.0	No. 145	No. 146	No. 147	No. 148	No. 149	+14.0	No. 150	No. 151
曲線	R=600 L=424.953										A=300 L=150.000										IP.4 1A=25-46-08 R=1000.000 CL=449.750 TL=228.744 SL=25.828																					
片勾配摺付図	±3.00%															±2.00%															±2.00%											